

Current BPU Satellite Storage Container

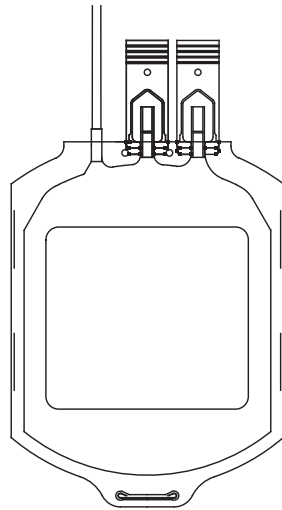

Revised BPU Satellite Storage Container

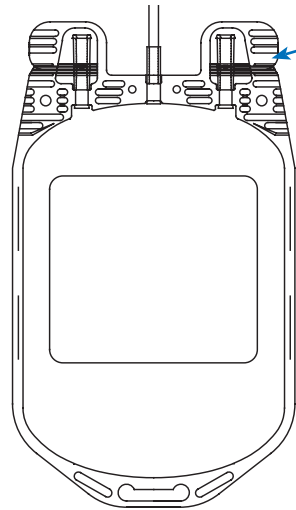

Integrated Tab Design

Larger Container (600ml)

Non-DEHP Material



Bioflex[®] RC Blood-Pack[®] Unit

Now with a Single Hand Motion Tab Opening

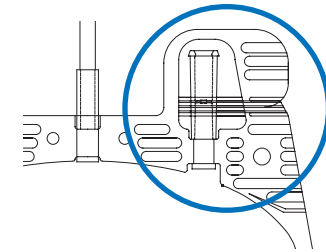

Current BPU RBC Storage Container

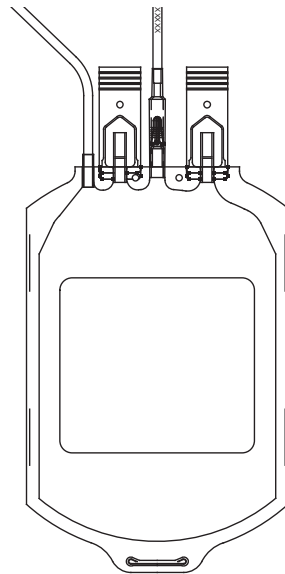

Revised BPU RBC Storage Container

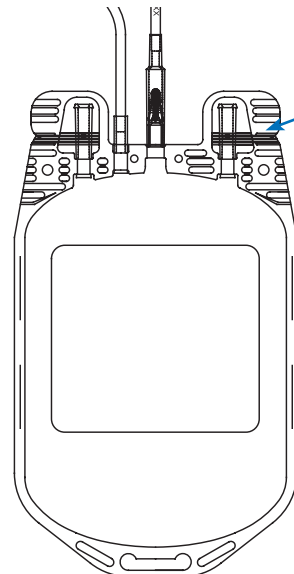

Integrated Tab Design

Non-DEHP Material



Bioflex® RC Blood-Pack® Unit

The Bioflex RC Blood-Pack Unit (BPU) is a disposable Red Cell (RC) Leukoreduction Filtration system (Bioflex RC BPU).

The red cell storage container and satellite container components of the BPU are joined with transfusion sets via the BPU spike port when transfusing blood products.

The Bioflex RC BPU has recently undergone container design revisions and material changes.

- The integrated tab design is functionally equivalent to the previous version.
- Spike port is ISO 3826-1 compliant.
- All blood component storage containers continue to be a non-DEHP (BTHC) from alternate supplier.

Revised Spike Port Design

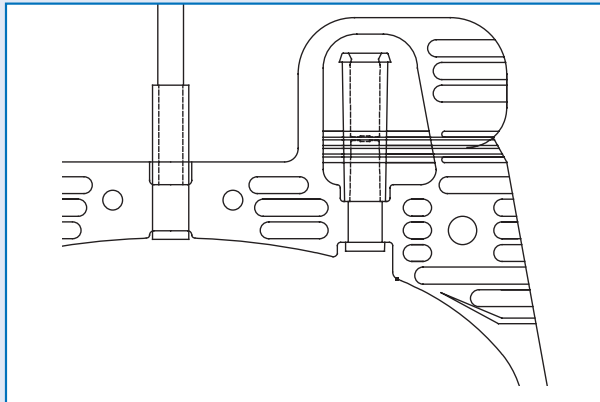

Increased area and more positive grip for tab-opening

▶ Previous Tab - Peel Design



▶ Revised Tab - Tear Design

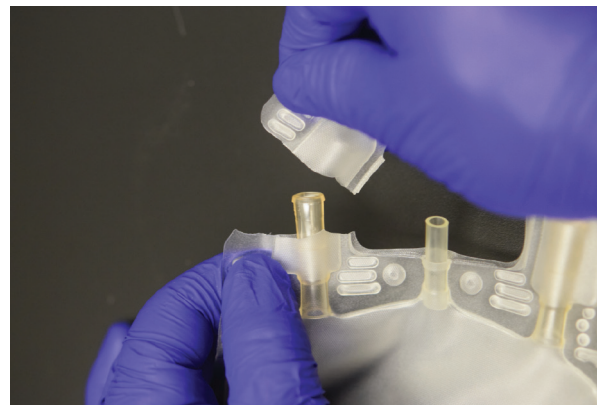
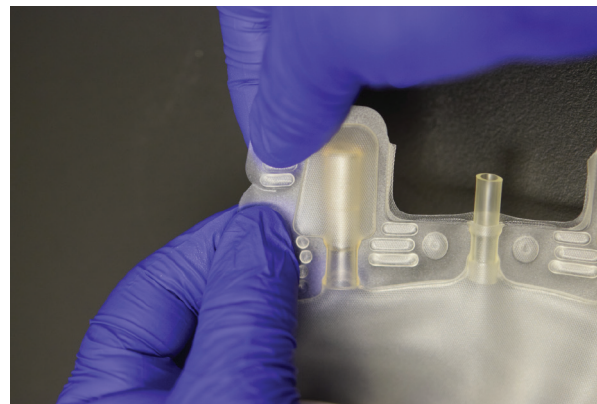

Refer to the Directions for use for a complete list of warnings and precautions associated with the use of this product.

All trademarks referred to are property of their respective owners. Copyright © 2021 Fresenius Kabi AG. All rights reserved



US Headquarters:
Fresenius Kabi
Three Corporate Drive
Lake Zurich, Illinois 60047
1-800-937-5060
www.fresenius-kabi.us

0109-BPU-01-07/21
December 2021